

1. Air Chiller Units

straight installation



1 Bäcker-Snack® IMPULSE

The clever solution for impulse sale



Preferred application:
Cakes, tartes, snacks with a merchandise height up to 6 cm.

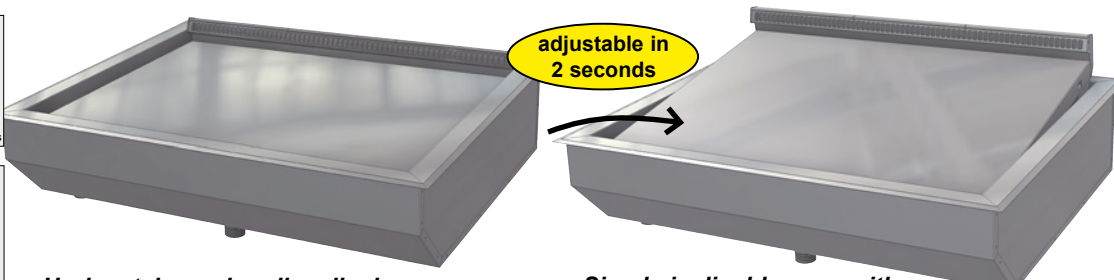

Horizontal merchandise display for cream cakes.

Simply inclinable even with loaded merchandise display.

Food stays fresh for longer thanks to the patented FRESHNESS SYSTEM

- Inclinable merchandise display (MOVE-UP)
- The air cooler can be easily folded down (MOVE-DOWN), in case of R134a/R513A with additional gas pressure springs
- Longer operating life of the cooling unit (LONG-LIFE)
- Hygienic base with round shaped corners (ROUND-BOTTOM)

Base element UTB 51 optionally available, see table on page 386.

- Easy cleaning of the air blow-off area (EASY-CLEAN)
- 4°C cooling technology
- 2 air speeds
- Liftable evaporator
- Separate mounting frame
- Durable technology

WIHA Bäcker-Snack IMPULSE	For external cooling unit	With cooling unit and controller	Cooling power [-10°ET]	Connection cooling unit	
Modell	Art.-No.	Art.-No.			
Bäcker-Snack IMPULSE 400 *	6015	20120	370 W	230V/210W	■
Bäcker-Snack IMPULSE 600 *	6016	20121	370 W	230V/270W	■
Bäcker-Snack IMPULSE 800	6017	20122	450 W	230V/350W	■
Bäcker-Snack IMPULSE 1200	6018	20123	605 W	230V/390W	■
Bäcker-Snack IMPULSE 1600	6019	20124	825 W	230V/540W	■
Bäcker-Snack IMPULSE 1600 D (2 air coolers)	6020	20125	825 W	230V/540W	■
Bäcker-Snack IMPULSE 2000 D (2 air coolers)	6021	20126 **	1060 W	230V/1023W	■

Delivery includes mounting frame. The refrigeration units for external cooling units include an expansion valve for R134a/R513A and built-in temperature sensors.

The patented WIHA FRESHNESS SYSTEM, protective machine cover and condensate pan/drain trap are available as accessories.

* Not available with FRESHNESS SYSTEM. ** Without base element, the cooling unit is connected via refrigerant couplings.

Special Accessories

	Art.-No.
Condensate pan mounted under the colling unit	33196
Drain fitting 1 1/4" for connecting to the customer's drain	3815
Reference thermometer for the customer side TPE 2	2182
TMP 620 controller for external cooling unit	12201
TMP 630 instead of TMP 620 with 2 freely usable outputs	12210
Detachable control panel (SPLIT-CONTROL)	12219
extra charge for device with cooling unit in the base housing	33194
Protective machine cover type 370-825	33195
Protective machine cover type 825 (2 air coolers)	33195
Air cooler for operation with refrigerant CO₂	10197
(price per air cooler, design see page 384)	

Patented WIHA FRESHNESS SYSTEM see page 31.

Description

Chiller unit with circulating air for cooling cakes, tartes and snacks with a merchandise height of up to 6 cm. The merchandise display can be set horizontally or at an angle for impulse sale (MOVE-UP FUNCTION). To operate it, the customer should provide a glass top that should only be open on the air blow-off side. Temperature: < 5°C at 25°C/60% relative humidity (climate class 3 according to DIN EN ISO 23953).

Commercial product for the installation in stationary food and service counter.

Design

Interior pan is made entirely of stainless steel, material 1.4301, with flush threaded drain fitting (1 1/4") and round shaped hygienic corners (ROUND-BOTTOM) that are easy to clean. Pressure-injected expanded polyurethane insulation (CFC-free). The exterior is made of galvanised sheet steel. Inside the pan is a circulating air evaporator with coated surface and quiet low-voltage ventilators (12 V DC) for air circulation. Located above the circulating air evaporator is a merchandise display made of ground stainless steel, material 1.4301. The air blow-off area can be easily unfolded, so that the inner surfaces can be cleaned of crumbs and remains of cream (EASY-CLEAN). To clean the pan bottom, the merchandise display with circulating air evaporator and ventilators can be folded upwards and locked in the top position via gas pressure springs. To clean the surfaces of the evaporator, the impulse nozzle can be swung up and then the evaporator can be folded down (MOVE-DOWN TECHNOLOGY) when the merchandise display is open. To clean the area behind the pan or to carry out servicing, the merchandise display can be moved forwards (MOVE-AWAY TECHNOLOGY). Installation is made easy by the mounting lip and stainless steel mounting frame. The surface of the mounting frame is ground.

For external cooling unit

Delivery includes:

- Expansion valve for R134a/R513A
- Built-in temperature sensor and defrost sensor

Cooling Unit Model

Description see „Bäcker-Snack Standard“ (page 10).

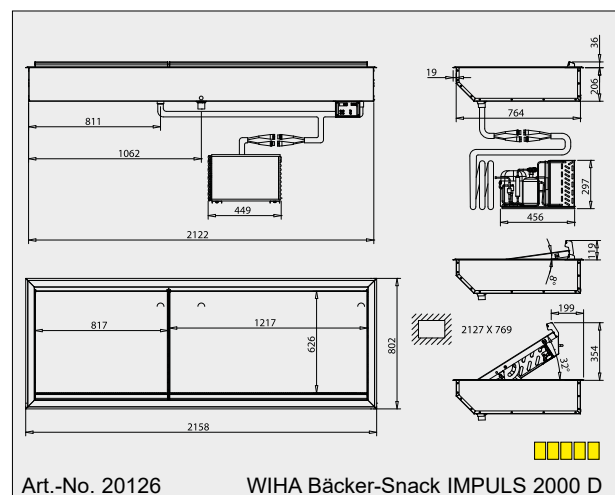
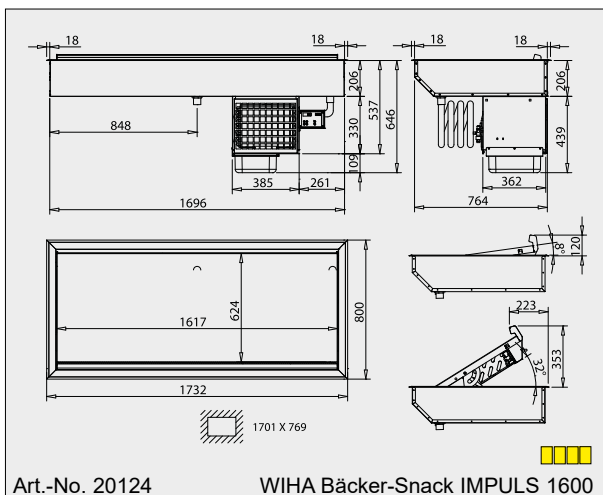
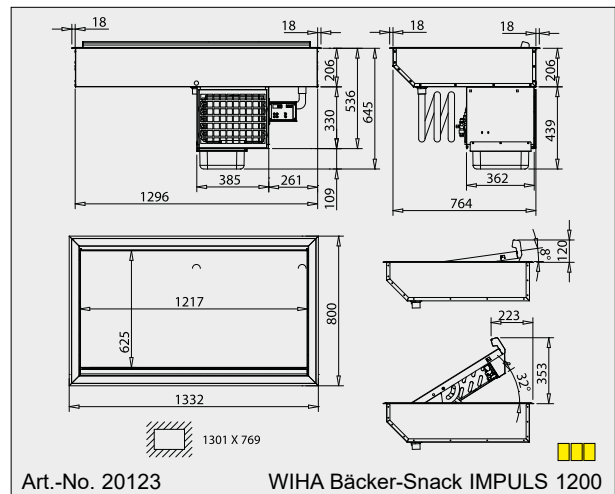
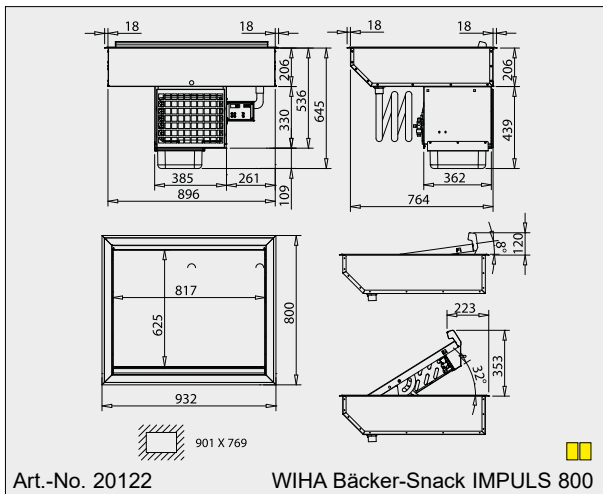
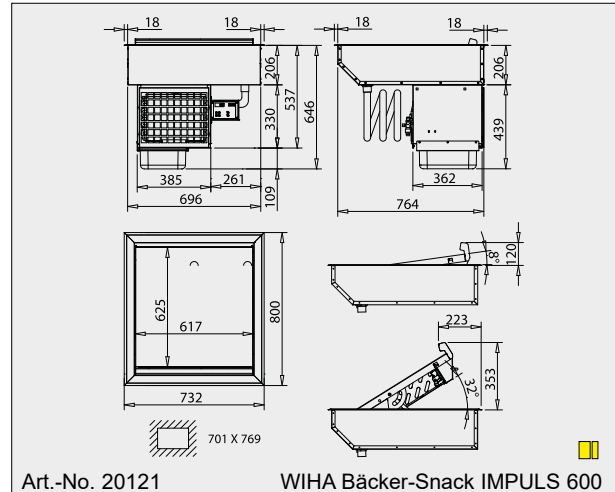
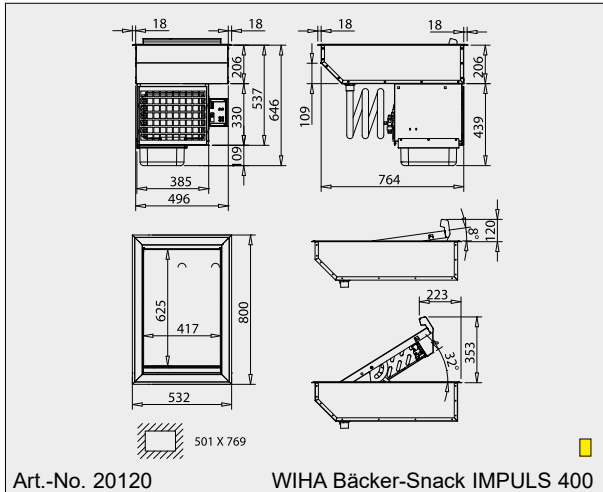

The drawings are shown with special accessory that is not included; more drawings are available on www.wiha-web.com under "Info Centre / Customer Area".

For external cooling units we recommend our
WIHA controller TMP 620
Art.-No. 12201

More information about the controller in chapter 16 on page 389.



Longer operating life of the cooling unit. The WIHA-LONG-LIFE technology protects the cooling unit permanently from overloads e.g. due to inadequate cleaning or poor ventilation. In case of overload an alarm occurs. WIHA-LONG-LIFE avoids unnecessary wear and cost-intensive maintenance and repair.