

7. Display Cases – combined

different temperature zones



Snack-Counter COMBI HOT+COLD 520

Combination of heated display case and refrigerated display case with circulating air – serve-over version



WiHA
Toughened Safety Glass
The front pane, side panes and glass shelves are made of toughened safety glass.

WiHA
MOVE-DOWN
Patented

WiHA
MOVE-AWAY
Patented

WiHA
LED
energy-saving & low-maintenance

WiHA
LONG-LIFE
Longer operating life of the cooling unit

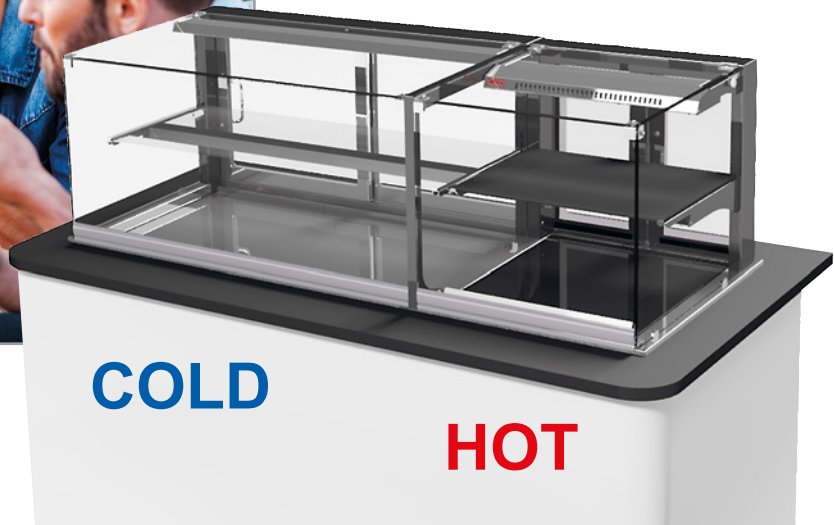

7

Combined Display Cases

Reliable refrigerated display case with circulating air

- Perfect illumination of the merchandise display area by LED lighting (warm colour reproduction)
- Better presentation of the goods thanks to inclinable merchandise display and intermediate shelf
- Intermediate shelf is also adjustable in height to match the height of the goods
- Easy to clean thanks to the liftable evaporator, the MOVE-DOWN function and the MOVE-AWAY function
- Also usable without refrigeration as a neutral illuminated display case

Tip:

Can now also be combined with the 520 high display cases from the Snack-Counter series.

Unique! Heated display case with even circulating air and adjustable humidity

- Adjustable humidity (6 steps) for optimum product quality
- Fully automatic steam generator with tank/pump system for automatic water filling
- Powerful circulating air heater for even temperature distribution
- Quick reheating after opening the doors
- No or very slight fogging of the glass panes even at higher humidity
- Easy cleaning of the removable humidifier tray
- Good illumination of the merchandise room by a temperature-resistant lighting
- No water connection or drain required
- Temperature can be adjusted digitally up to approx. 75°C
- Merchandise displays are made of toughened black glass

Snack-Counter COMBI HOT+COLD 520	With cooling unit and controller	Width [mm]	Cooling-power [-10°ET]	Connection
	 angled			
Snack-Counter COMBI HC 520 - 2k+1.5	33104	1309	370 W	230V/2.9 kW
Snack-Counter COMBI HC 520 - 3k+1.5	33106	1634	370 W	230V/2.9 kW

Protective machine cover and condensate pan/drain trap are available as accessories.

Special Accessories

	Art.-No.
Condensate pan mounted under the cooling unit	33266
Drain fitting 1 1/4" for connecting to the customer's drain	3815
Protective machine cover type 370/450	8179

	Art.-No.
Price label rails for the refrigerated display case:	
Price label rail glass shelf GN 2	11241
Price label rail glass shelf GN 3	11242
Price label rail lower display area GN 2	11251
Price label rail lower display area GN 3	11252

Description

This device is a combination of a heated display case and a refrigerated display case with circulating air.
Both parts of the device can be operated independently of one another.

Description Refrigerated Display Case

Refrigerated display case with circulating air for cooling cakes, cream cakes and snacks.
The customer side has an angled glass construction made of safety glass.
The glass shelves are height adjustable and can be set at an angle, which means better presentation.
Perfect illumination of the merchandise display area by LED lighting (warm colour reproduction).
Temperature: < 7°C at 25°C/60% relative humidity (climate class 3 according to DIN EN ISO 23953).
Humidity: approx. 70% to 85%.
Commercial product for the installation in stationary food and service counter.

Description Heated Display Case

Heated display case with circulating air heating for keeping all types of foods warm.
For optimum product quality, the inside temperature is adjustable from 40 to 75 °C and the humidity in 6 steps.
The steam generator operates fully automatic.
The merchandise areas are made of toughened black glass.
All display levels are equipped with quartz radiators (medium and long-wave infrared radiation) and a temperature-resistant lighting (warm colour reproduction).
All components are easily accessible for maintenance and cleaning.
Keep warm temperature > 65 °C (at room temperature > 20 °C).
Commercial product for the installation in stationary food and service counter.

Design Refrigerated Display Case

Construction, merchandise display and interior pan are made entirely of stainless steel, material 1.4301. Pan interior is finished with 1 1/4" flush threaded drain fitting and hygienic corners that are easy to clean. Pressure-injected expanded polyurethane insulation. The exterior is made of galvanised sheet steel. Inside the pan is a generously sized circulating air evaporator with coated surface and quiet low-voltage ventilators (12 V DC) for air circulation. Located above the circulating air evaporator is a merchandise display made of ground stainless steel, material 1.4301.
To clean the pan bottom, the merchandise display with circulating air evaporator and ventilators can be folded upwards and locked in the top position via gas pressure springs. For easy cleaning of the evaporator, it can be folded down (MOVE-DOWN FUNCTION) when the merchandise display is open. To clean the area behind the pan or to carry out servicing, the merchandise display can be moved forwards (MOVE-AWAY FUNCTION).

The front glass pane is made of safety glass and can be swung outwards for easy cleaning. The side glass panes and the height adjustable shelves are also made of safety glass. For good illumination, a shielded LED light (standard colour: white) is mounted above each shelf. The shelves are suitable for Gastro-Norm dimensions. The mounting lip makes installation easy.
With WIHA-LONG-LIFE for a longer operating life of the cooling unit.

The operator side has sliding doors made of insulating glass, easily removable for cleaning (without bottom rail).

For external cooling unit

- Delivery includes:
- Expansions valve for R134a/R513A
 - Digital defrost and temperature controller

Design Heated Display Case

Interior and exterior are made entirely of stainless steel with high-temperature resistant insulation. All visible sides have a ground surface.
The front glass pane is made of safety glass. It can be swung outwards for easy cleaning. The side glass panes are also made of safety glass.
The heating is made by a powerful circulating air heater blower and powerful quartz radiators with medium and long-wave infrared radiation.
The steam generator operates fully automatically and is equipped with an automatic water filling system. The humidifier tray of the steam generator can be easily removed for cleaning. It can be cleaned in a dishwasher.
An empty water tank is shown in the display. In addition, there is a short signal tone that reminds you every 20 seconds that there is an error message.

Version "Tank/Pump System"

The water filling of the steam generator is made automatically via a tank/pump system. The water tank can be placed under the device in the counter furniture and can be easily removed for daily filling.

The digital defrost and temperature controller is mounted beneath the heated display case. The control panel is equipped with a large graphic display and contains versatile functions.

The operator side has wing doors made of insulating glass.

Cooling Unit Model

The cooling unit is encased in a stainless steel housing and is located beneath the cooling pan. It is easy to remove for servicing.
A condensate pan is available as accessory.

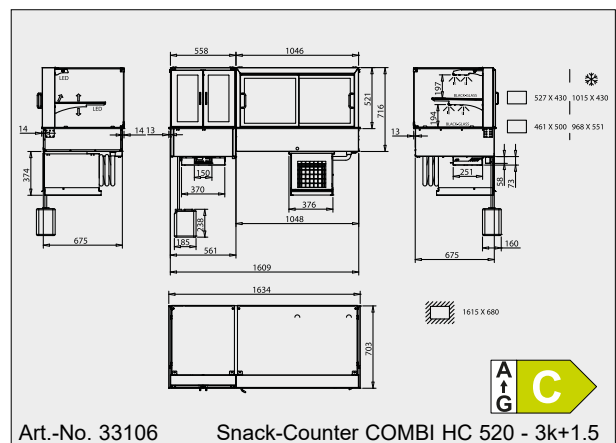
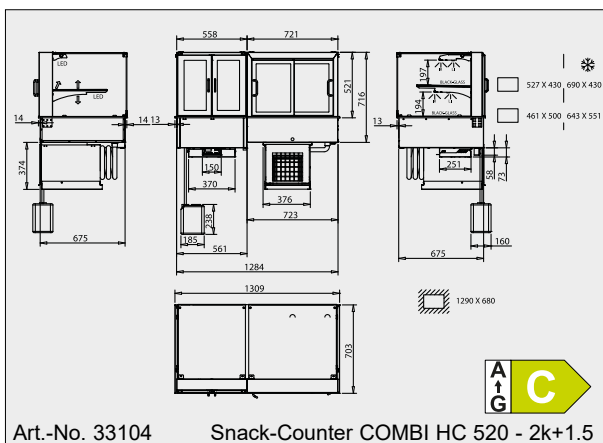

The drawings are shown with special accessory that is not included.