

7. Display Cases – combined

different temperature zones



Euro-Counter COMBI

The serve-over display case for cooled and uncooled products – display areas are suitable for Euro-Norm trays

Freshness System (Special Accessory) Patented	LED energy-saving & low-maintenance
Toughened Safety Glass The front pane, side panes and glass shelves are made of toughened safety glass.	LONG-LIFE Longer operating life of the cooling unit
MOVE-DOWN Patented	SPLIT-CONTROL (Special Accessory) Flat and removable control panel
MOVE-AWAY Patented	Soft-Close Soft-closing sliding doors Special Accessory

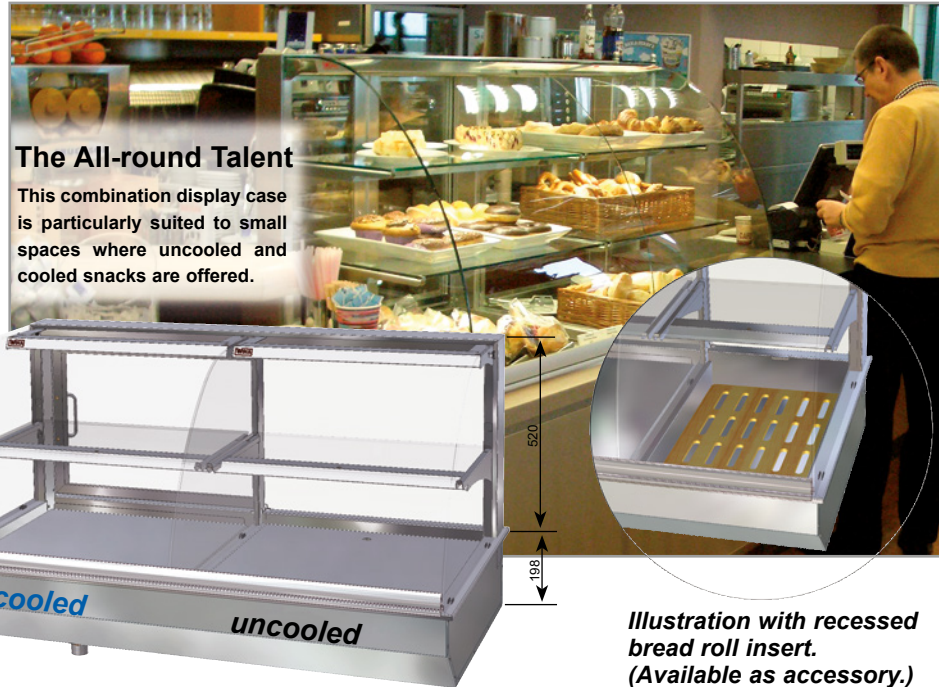

The All-round Talent

This combination display case is particularly suited to small spaces where uncooled and cooled snacks are offered.

Illustration with recessed bread roll insert. (Available as accessory.)

Option: Light colour adjustable, see page 141.

Euro-Counter 520 COMBI BE	For external cooling unit incl. controller			With cooling unit and controller			Width [mm]	Cooling power [-10°ET]	Connection
Serve-over version Height glass top 520 mm	round	angled	slanted	round	angled	slanted			
Euro-Counter 520 COMBI BE 400k+400 *	14728	14748	16400	14729	14749	16412	922	370 W	230V/330W
Euro-Counter 520 COMBI BE 600k+600 *	14726	14779	16401	14727	14780	16413	1322	370 W	230V/340W
Euro-Counter 520 COMBI BE 800k+400	14730	14781	16402	14731	14782	16414	1322	370 W	230V/340W
Euro-Counter 520 COMBI BE 400+400k *	14736	14789	16403	14737	14790	16415	922	370 W	230V/330W
Euro-Counter 520 COMBI BE 600+600k *	14738	14791	16404	14739	14792	16416	1322	370 W	230V/340W
Euro-Counter 520 COMBI BE 400+800k	14740	14793	16405	14741	14794	16417	1322	370 W	230V/340W

The FRESHNESS SYSTEM (circulated air disinfection), protective machine cover and condensate pan/drain trap are available as accessories. * Not available with FRESHNESS SYSTEM.

Euro-Counter 710 COMBI BE	For external cooling unit incl. controller			With cooling unit and controller			Width [mm]	Cooling power [-10°ET]	Connection
Serve-over version Height glass top 710 mm	round	angled	slanted	round	angled	slanted			
Euro-Counter 710 COMBI BE 400k+400 *	14722	14783	16406	14723	14784	16418	922	370 W	230V/350W
Euro-Counter 710 COMBI BE 600k+600 *	14720	14785	16407	14721	14786	16419	1322	450 W	230V/420W
Euro-Counter 710 COMBI BE 800k+400	14724	14787	16408	14725	14788	16420	1322	450 W	230V/420W
Euro-Counter 710 COMBI BE 400+400k *	14742	14795	16409	14743	14796	16421	922	370 W	230V/350W
Euro-Counter 710 COMBI BE 600+600k *	14744	14797	16410	14745	14798	16422	1322	450 W	230V/420W
Euro-Counter 710 COMBI BE 400+800k	14746	14799	16411	14747	14800	16423	1322	450 W	230V/420W

The FRESHNESS SYSTEM (circulated air disinfection), protective machine cover and condensate pan/drain trap are available as accessories. * Not available with FRESHNESS SYSTEM.

Special Accessories

Condensate pan mounted under the cooling unit

Drain fitting 1 1/4" for connecting

to the customer's drain

Protective machine cover type 370/450

Air cooler for operation with refrigerant CO₂

(design see page 384)

Option soft-close (soft-closing sliding doors)

Patented WiHA FRESHNESS SYSTEM see page 126.

A recessed stainless steel insert for bread rolls (or the like) can be mounted in the uncooled area in place of the base display. The bottom area is equipped with a wooden grate.

Bread roll insert, size 400

Bread roll insert, size 600

Art.-No.

33266

3815

8179

10197

4711

14760

14761

Art.-No.

Price label rail Euro-Counter COMBI glass shelf 400* 11479

Price label rail Euro-Counter COMBI glass shelf 600* 11480

Price label rail Euro-Counter COMBI glass shelf 800 11481

* Note: Suitable for cooled and uncooled area.

Price label rail Euro-C. COMBI lower display area 400 11482

Price label rail Euro-C. COMBI lower display area 600 11483

Price label rail Euro-C. COMBI lower display area 800 11484

The price label rail for the uncooled lower display area is available on request.

Description

Combination display case with circulation air for cooled and uncooled products. The customer side has a rounded, angled or slanted glass construction made of safety glass. The glass shelves are height adjustable and can be set at an angle, which means better presentation.
 Temperature: < 7°C at 25°C/60% relative humidity (climate class 3 according to DIN EN ISO 23953).
 Humidity: approx. 70% to 85%.
 Commercial product for the installation in stationary food and service counter.

Design

The combination display case is equipped with a cooled area with plain merchandise display and an uncooled area with recessed merchandise display.
 Construction, merchandise display and interior pan are made entirely of stainless steel material 1.4301. Pan interior is finished with 1 1/4" flush threaded drain fitting and hygienic corners that are easy to clean. Pressure-injected expanded polyurethane insulation. The exterior is made of galvanised sheet steel. Inside the pan is a generously sized circulating air evaporator with coated surface and quiet low-voltage ventilators (12 V DC) for air circulation. Located above the circulating air evaporator is a merchandise display made of ground stainless steel material 1.4301.
 To clean the pan bottom, the merchandise display with circulating air evaporator and ventilators can be folded upwards and locked in the top position via gas pressure springs. The evaporator can be folded down and away from the merchandise display for easy cleaning (MOVE-DOWN FUNCTION). To clean the area behind the pan or to carry out servicing, the merchandise display can be moved forwards (MOVE-AWAY FUNCTION).

The front glass pane is made of safety glass and can be swung outwards for easy cleaning. The side glass panes and the height adjustable shelves are also made of safety glass. For good illumination, a shielded LED light (standard colour: white) is mounted above each shelf. The mounting lip makes installation easy.
 A digital defrosting and temperature controller is mounted beneath the cooling pan. Two air speeds can be selected for different foods. The flat control panel (installation depth: approx. 20 mm) can be removed for mounting in the counter front (cable length: approx. 1 m).
With WIHA-LONG-LIFE for a longer operating life of the cooling unit.

The uncooled area is open on the operator side, the cooled area is equipped with sliding doors made of insulating glass. Delivery includes CNS merchandise display for uncooled area.

For external cooling unit

- Delivery includes:
- Expansion valve for R134a/R513A
 - Digital defrost and temperature controller

Cooling Unit Model

The cooling unit is encased in a stainless steel housing and is located beneath the cooling pan. It is easy to remove for servicing.
 A condensate pan is available as accessory.

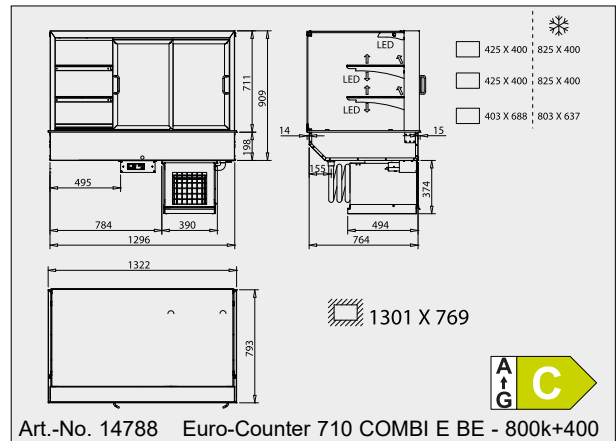
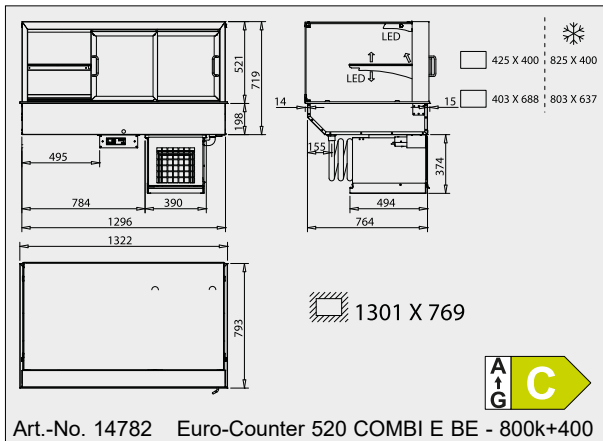
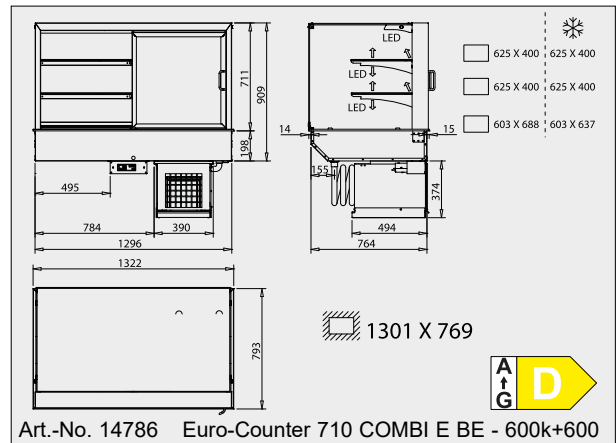
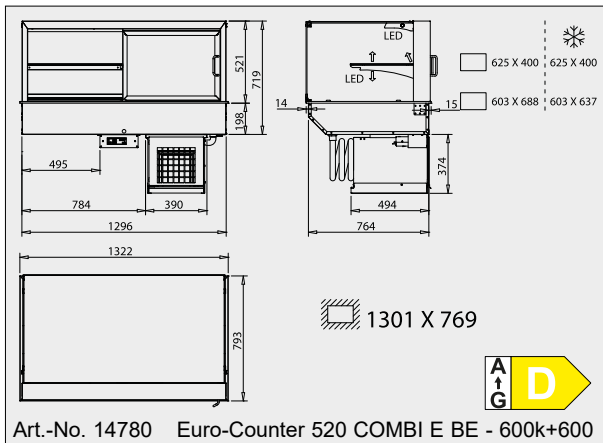
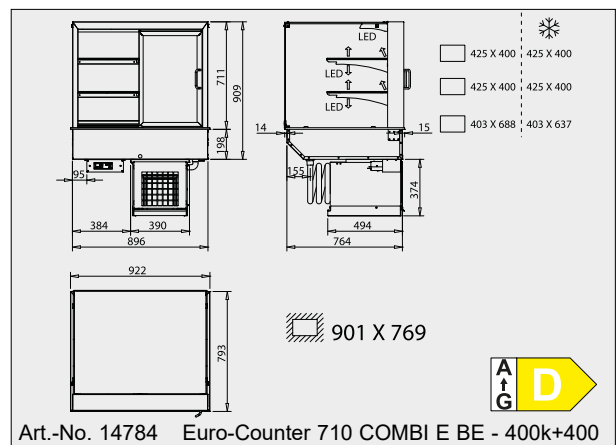
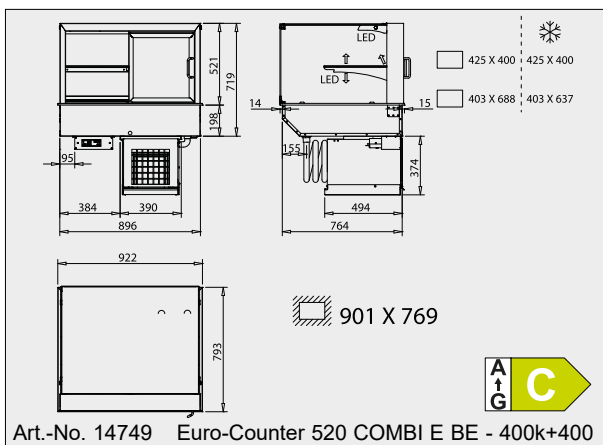

The drawings are shown with special accessory that is not included in the scope of delivery; more drawings are available on www.wiha-web.com under "Info Centre / Customer Area".